



*Move and dump  
drums up to  
four times faster.*



## DRUM CLAMPS

# Efficient and safe multiple drum handling.

### APPLICATIONS

Drum clamps are used wherever product is stored in drums, including the petroleum, chemical and food processing industries. Drum clamps improve productivity by allowing a forklift driver to handle up to four drums per load. In addition, the use of a drum clamp allows the driver to securely grip the drums for transporting. This eliminates instability during braking and cornering, which is a common problem when attempting to handle drums with conventional forks.

### FEATURES

- Proven, durable arm and aluminum frame construction ensuring long, useful life of the clamp
- Superior arm-slide material and design for extended bearing life
- Arm design for handling standard 55-gallon drums—standard
- Replaceable rubber faced arm pads
- Regenerative hydraulic valving for optional arm speed

### OPTIONS

- Custom arm radiuses for special drum sizes
- Custom arms for fiber and for plastic drums
- Custom arm lengths
- Class III mounting
- Quick Disconnect mounting
- Custom opening ranges

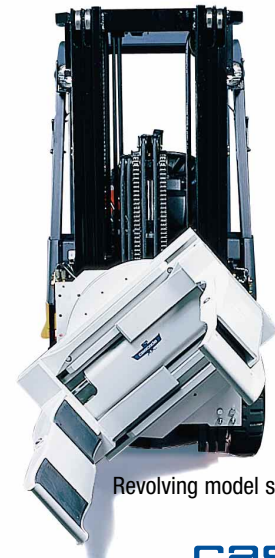

Revolving model shown

**cascade**  
corporation

# DRUM CLAMPS

## 2 Drum Clamp (handles 1 or 2 drums)

## 4 Drum Clamp (handles 1, 2 or 4 drums)

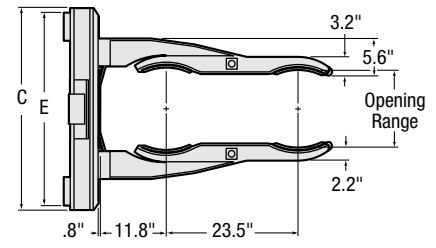
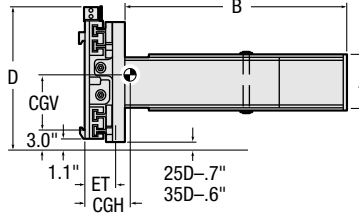
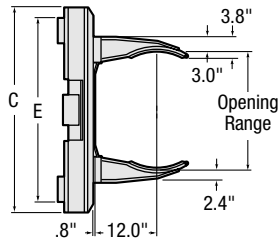
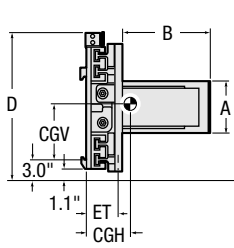

Capacity Lbs. @ 24" Load Center	Opening Range ①	Catalog Order No.	Mounting Class	Mounting Angle ②	Usable Arm Height A	Usable Arm Length B	Weight (Lbs.)	Effective Thickness ET	Horizontal Center of Gravity CGH	Vertical Center of Gravity CGV	Overall Width C	Overall Height D	Hook Spread E	Rotator Speed	Rotator Torque @ 2,000 PSI
<b>2-Drum Non-Sideshifting</b>															
2,500	19.0"-63.0"	25D-DTB-01A	II	N/A	9.2"	17.1"	595	5.5"	4.2"	8.3"	34"	24.5"	30"	N/A	N/A
3,500	20.5"-69.0"	35D-DTB-01A	II	N/A	9.2"	17.1"	650	5.7"	4.1"	8.7"	37"	25.3"	35"	N/A	N/A
<b>2-Drum Sideshifting</b>															
2,500	19.0"-63.0"	25D-DTS-11A	II	N/A	9.2"	17.1"	595	5.5"	4.2"	8.3"	34"	24.5"	30"	N/A	N/A
3,500	20.5"-69.0"	35D-DTS-11A	II	N/A	9.2"	17.1"	650	5.7"	4.1"	8.7"	34"	24.5"	30"	N/A	N/A
<b>2-Drum Revolving</b>															
3,500	20.5"-69.0"	35D-DTR-21A	II	0°	9.2"	17.1"	1,150	9.5"	5.5"	16.2"	37"	30.5"	32"	5.7 RPM	55,000
3,500	20.5"-69.0"	35D-DTR-21F	II	4°	9.2"	17.1"	1,150	8.5"	4.5"	16.2"	37"	30.5"	32"	@ 10GPM	In.-Lbs.
<b>4-Drum Non-Sideshifting</b>															
2,500	16.5"-61.0"	25D-DFB-02A	II	N/A	10.0"	41.8"	815	5.6"	12.3"	8.3"	34"	24.5"	30"	N/A	N/A
3,500	18.0"-66.5"	35D-DFB-02A	II	N/A	10.0"	41.8"	870	5.8"	11.6"	8.7"	37"	25.3"	35"	N/A	N/A
<b>4-Drum Sideshifting</b>															
2,500	16.5"-61.0"	25D-DFS-12A	II	N/A	10.0"	41.8"	815	5.6"	12.3"	8.3"	34"	24.5"	30"	N/A	N/A
3,500	18.0"-66.5"	35D-DFS-12A	II	N/A	10.0"	41.8"	870	5.8"	11.6"	8.7"	37"	25.3"	35"	N/A	N/A
<b>4-Drum Revolving</b>															
3,500	18.0"-66.5"	35D-DFR-22A	II	0°	10.0"	41.8"	1,350	9.4"	10.9"	13.2"	37"	30.5"	32"	5.7 RPM	55,000
3,500	18.0"-66.5"	35D-DFR-22F	II	4°	10.0"	41.8"	1,350	8.4"	9.9"	13.2"	37"	30.5"	32"	@ 10GPM	In.-Lbs.

- ① Opening range is to inside of curvature of drum pad.
- ② Vertical mount (0° mounting angle) is recommended for lift heights exceeding 180".

▶ Clamps above are designed for standard 55 gallon steel drums with two rolling rings. Smooth steel, plastic or fiber drums require special pads. Please consult Cascade.

### INSTALLATION KITS

Model	Catalog Order No.
Non-Sideshifting	659245
Sideshifting	659249
Revolving	672442

### HYDRAULIC FLOW AND PRESSURE

Model	Minimum	Recommended	Maximum	Max. Pressure
25D	4 GPM	5.5 GPM	5.5 GPM	2,300 PSI
SS & Non-SS 35D	4 GPM	7 GPM	7 GPM	2,300 PSI
Revolving 35D	5 GPM	10 GPM	12 GPM	2,300 PSI

### HYDRAULIC FUNCTIONS

Model	Hydraulic Functions	Truck Auxiliary Valves Required
Non-Sideshifting	1	1
Sideshifting, Revolving	2	2

### MOUNTING CLASS INFORMATION

Mounting Class	Truck Capacity
II	2,000-5,500 lbs.

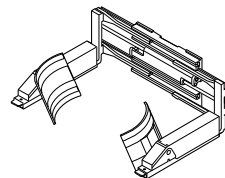

### Forward Drum Dumper

Slip-on dual powered 180° forward drum dumper arms. Handles steel drums. Replaceable rubber-faced pads for minimum drum damage. Forks 48" long. Optional combination pads for plastic or steel drums. **Consult Cascade.**

Model	Weight (Lbs.)
25D-FDD-03A	1,240
35D-FDD-03A	1,350
50D-FDD-03A	1,610